

# CLICKCLAD: FLANGE & VALVE COVER

1. For the Flange and Valve Covers, there are 3 simple shapes available Cylinder, Flat Top, Box.
2. When you decide on the shape of the flange and valve cover. Consider valve type, valve accessories and any other obstruction such as wall, pipe layout.
3. Minimum diameter of the Clickclad sysetm is 75mm.
4. When installing give yourself enough clearence. 15- 25mm  
Example 200 W x195 H x 250 L mm = 215 W x210 H x 265 L mm
5. Each unit comes with its own set of bands

[ VC - CYLINDER ]

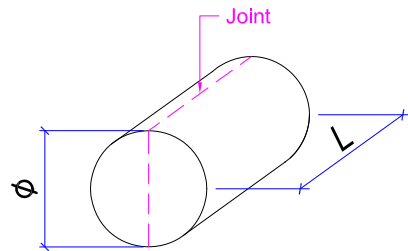

[ VF - FLAT TOP ]

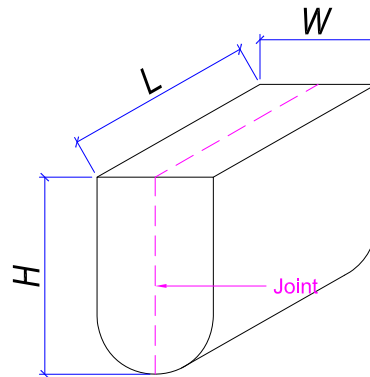

[ VB - BOX ]

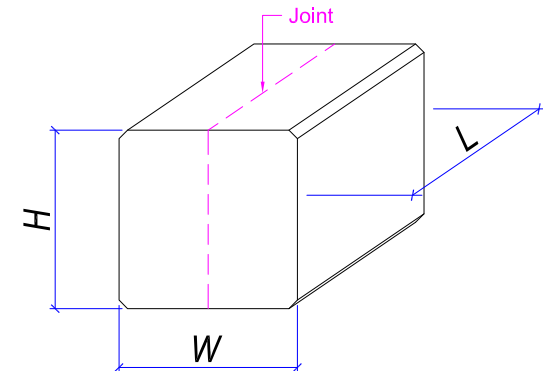

Add. Unit 7, 26 James St.  
LIDCOMBE, NSW 2141  
Tel. 1300 186 667  
Mobile. 0412 284 153  
Fax. 1300 176 776  
Web. [www.clickclad.com.au](http://www.clickclad.com.au)  
E-mail. [Info@clickclad.com.au](mailto:Info@clickclad.com.au)

Revision no.  
**0**  
23.02.2015